

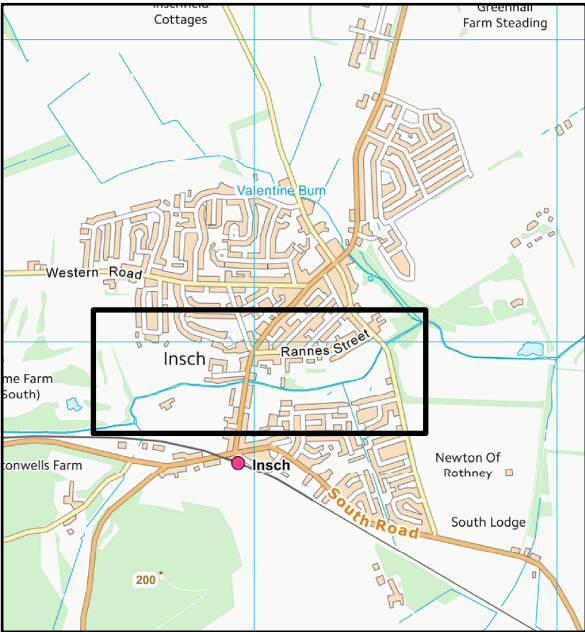

Embankment construction:  
130 m length  
Maximum height 1.75 m  
Defence level 124.85 mAOD

KEYPLAN Scale 1:25,000



LEGEND

 Embankment

0.5% AP (200 year) +CC SoP

Contains Ordnance Survey (C) Crown copyright and database right 2019



Insch - Final Options  
Option 1 - A1a  
Figure 1.2 (2 of 4)

Drawing no: AIZ-JBAU-IN-00-DR-HM-0002

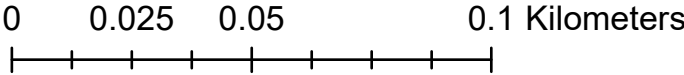



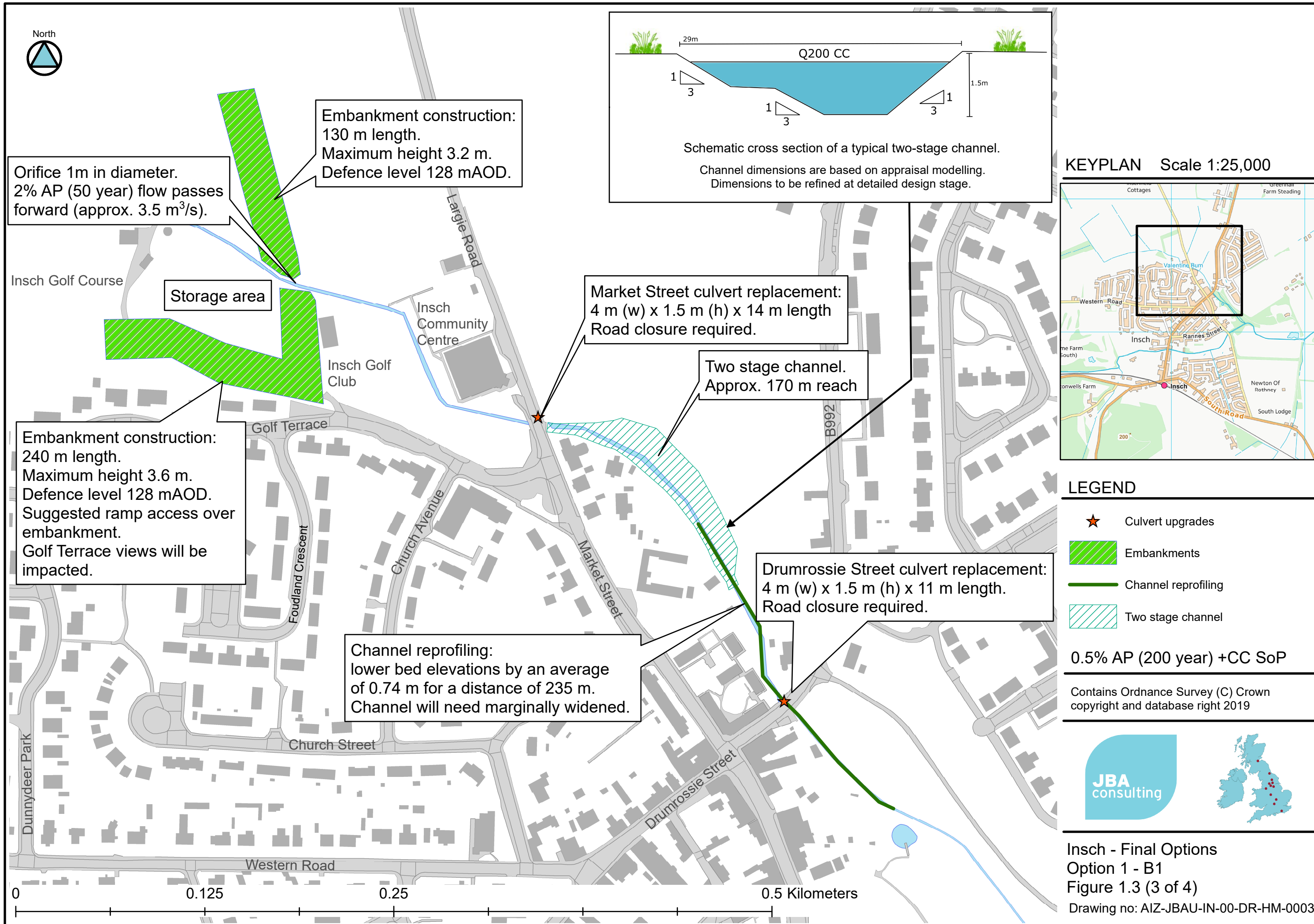

Orifice 1m in diameter.  
2% AP (50 year) flow passes  
forward (approx. 3.5 m³/s).

Embankment construction:  
130 m length.  
Maximum height 3.2 m.  
Defence level 128 mAOD.

Storage area

Embankment construction:  
240 m length.  
Maximum height 3.6 m.  
Defence level 128 mAOD.  
Suggested ramp access over  
embankment.  
Golf Terrace views will be  
impacted.

Market Street culvert replacement:  
4 m (w) x 1.5 m (h) x 14 m length  
Road closure required.

Two stage channel.  
Approx. 170 m reach

Drumrossie Street culvert replacement:  
4 m (w) x 1.5 m (h) x 11 m length.  
Road closure required.

Channel reprofiling:  
lower bed elevations by an average  
of 0.74 m for a distance of 235 m.  
Channel will need marginally widened.

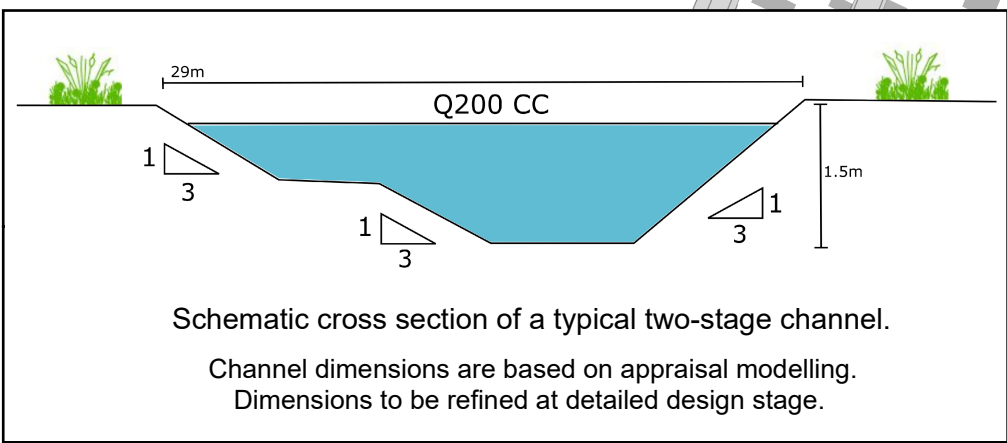

KEYPLAN Scale 1:25,000

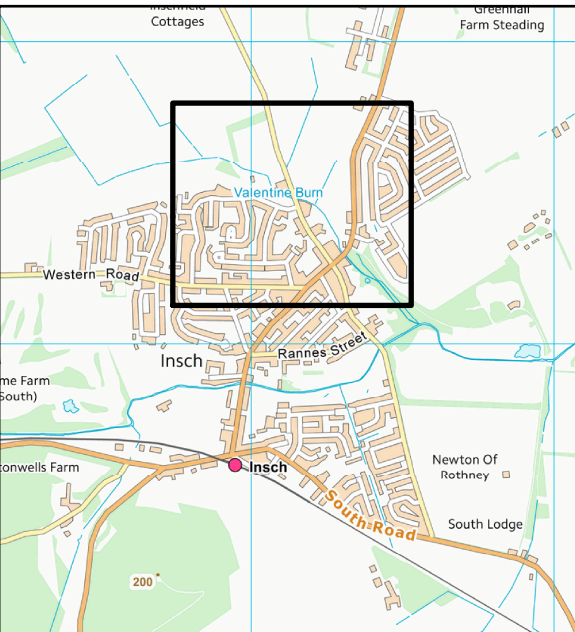

LEGEND

- ★ Culvert upgrades
- Embankments
- Channel reprofiling
- Two stage channel

0.5% AP (200 year) +CC SoP

Contains Ordnance Survey (C) Crown  
copyright and database right 2019



Insch - Final Options  
Option 1 - B1  
Figure 1.3 (3 of 4)

Drawing no: AIZ-JBAU-IN-00-DR-HM-0003

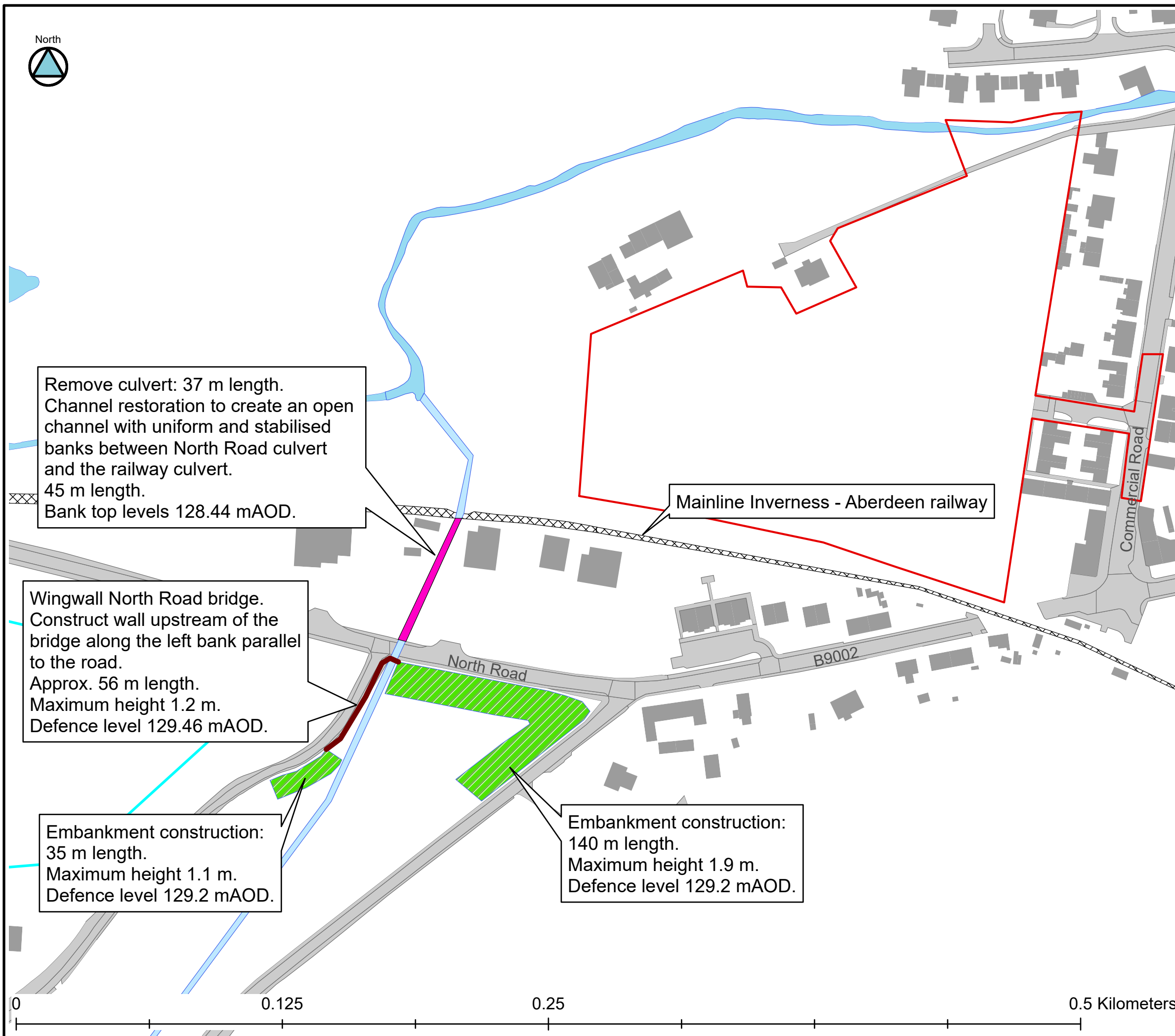

KEYPLAN Scale 1:25,000

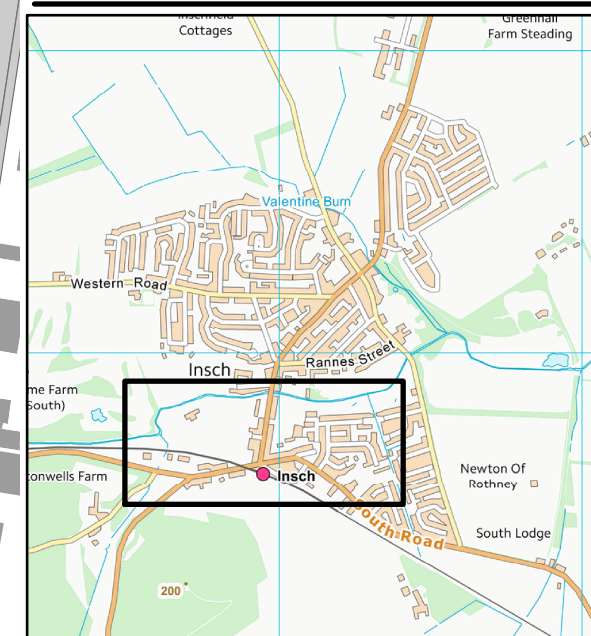

#### LEGEND

- Wall
- Development area (housing)
- Embankment
- Open channel

0.5% AP (200 year) +CC SoP

Contains Ordnance Survey (C) Crown  
copyright and database right 2019



Insch - Final Options  
Option 1 - C1

Figure 1.4 (4 of 4)

Drawing no: AIZ-JBAU-IN-00-DR-HM-0004